

Name _____

Date _____

Lesson 19: Computing Actual Areas from a Scale Drawing

Exit Ticket

1. A 1-inch length in the scale drawing below corresponds to a length of 12 feet in the actual room.

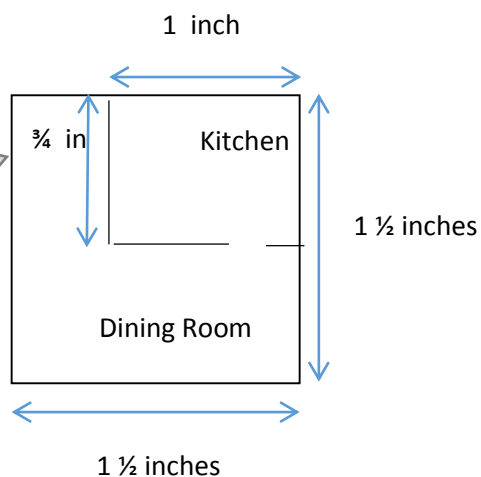

- a. Describe how the scale or the scale factor can be used to determine the area of the actual dining room.
- b. Find the actual area of the dining room.
- c. Can a rectangular table that is 7 ft. long and 4 ft. wide fit into the narrower section of the dining room? Explain your answer.